

G Series - GHDSS Refrigerated Self-Service Cases



Self-service multi-shelf merchandisers for deli items

Models

GHDSS3
GHDSS4
GHDSS6
GHDSS8
GHDSS12
GHDSSX2
GHDSSX4
GHDSSX9
GHDSSN2
GHDSSN4
GHDSSN9

Applications

- Forced air refrigeration
- Medium temperature integrated average of 41°F
- For refrigerated packaged deli or beverage items

Standard Features

- Black interior
- Painted exterior
- Black trim
- No end panels (specify ends per lineup)
- Open reach-in front
- Solid back panel
- Non-lighted solid shelves
- T-8 top light
- Electrical leads
- 13"D top header
- Energy-efficient evaporator fans
- Remote refrigeration with TXV
- ETL Certified to CAN/CSA 22.2, Conforms to UL 471 & NSF 7
- Meets DOE 2012 Energy Standards

Options

- White or stainless steel interior
- Stainless steel or laminated exterior
- Silver trim
- Full w/mirror, cutaway or case to case glass end panels.
- Clear glass rear sliding doors
- Lighted solid shelves - T-8 or LED
- 1" bumper on front
- Breeze™ self-contained refrigeration* with 6' power cord - specify levelers, casters, or 6"H legs
- Clean Sweep® condenser coil cleaner
- Night curtain or wire security cover
- Additional profiles available - see back page

*Increases height of case by approx. 4"

Specifications - GHDSS Refrigerated Cases

Model	L*xDxDH
GHDSS3	36-3/4"x 42-7/8"x 51-1/4"
GHDSS4	48-3/4"x 42-7/8"x 51-1/4"
GHDSS6	73-1/8"x 42-7/8"x 51-1/4"
GHDSS8	97-1/2"x 42-7/8"x 51-1/4"
GHDSS12	146-1/4"x 42-7/8"x 51-1/4"
GHDSSX2	47-1/4"x 43-3/8"x 51-1/4"
GHDSSX4	39-1/8"x 43-3/8"x 51-1/4"
GHDSSX9	72-1/4"x 43-3/8"x 51-1/4"
GHDSSN2	38-5/8"x 43-3/8"x 51-1/4"
GHDSSN4	53-1/4"x 43-3/8"x 51-1/4"
GHDSSN9	98-3/8"x 43-3/8"x 51-1/4"

*without 1" end panels

GHDSSX models = convex/outside curve
 GHDSSN models = concave/inside curve

STANDARD

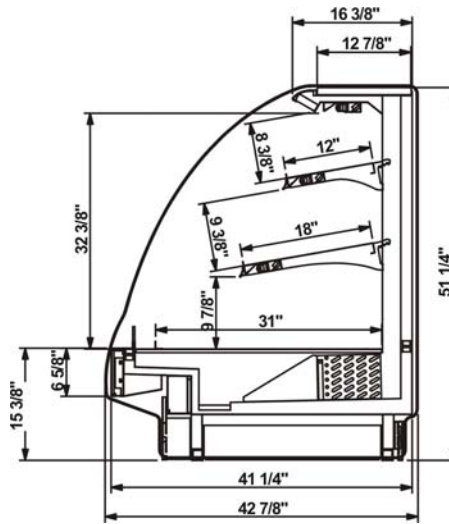

IMPORTANT NOTES

Units must be shimmed during installation to ensure the unit is level and plumb.

INTENDED ENVIRONMENT

Designed to operate in ambient conditions of 75°F with 55% relative humidity.

Integrated average product temperature of 41°F.

INTENDED USE

Packaged refrigerated products.

GHDSSX2 PLAN VIEW

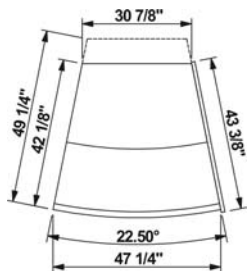

GHDSSX4 PLAN VIEW

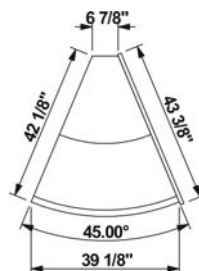

GHDSSX9 PLAN VIEW

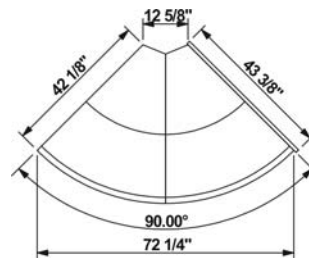

GHDSSN2 PLAN VIEW

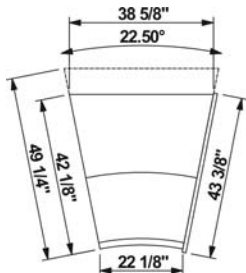

GHDSSN4 PLAN VIEW

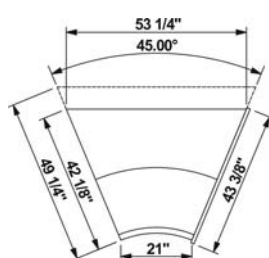

GHDSSN9 PLAN VIEW

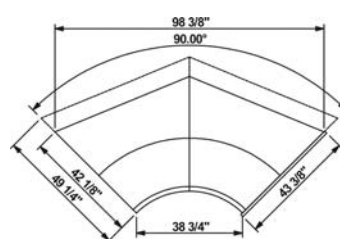

INFORMATION IS SUBJECT TO CHANGE WITHOUT NOTICE.



For more information on any of our products or services please visit us on the web at:

www.structuralconcepts.com