

OASIS[®]

COXXR-UC & COXX24R-UC Under-Counter Front Access Installation Guide / P/N 21-14733

This Under-Counter Guide Is Applicable To The Following Structural Concepts Models:

- > CO33R-UC, CO43R-UC, CO53R-UC and CO63R-UC
- > CO3324R-UC, CO4324R-UC, CO5324R-UC and CO6324R-UC

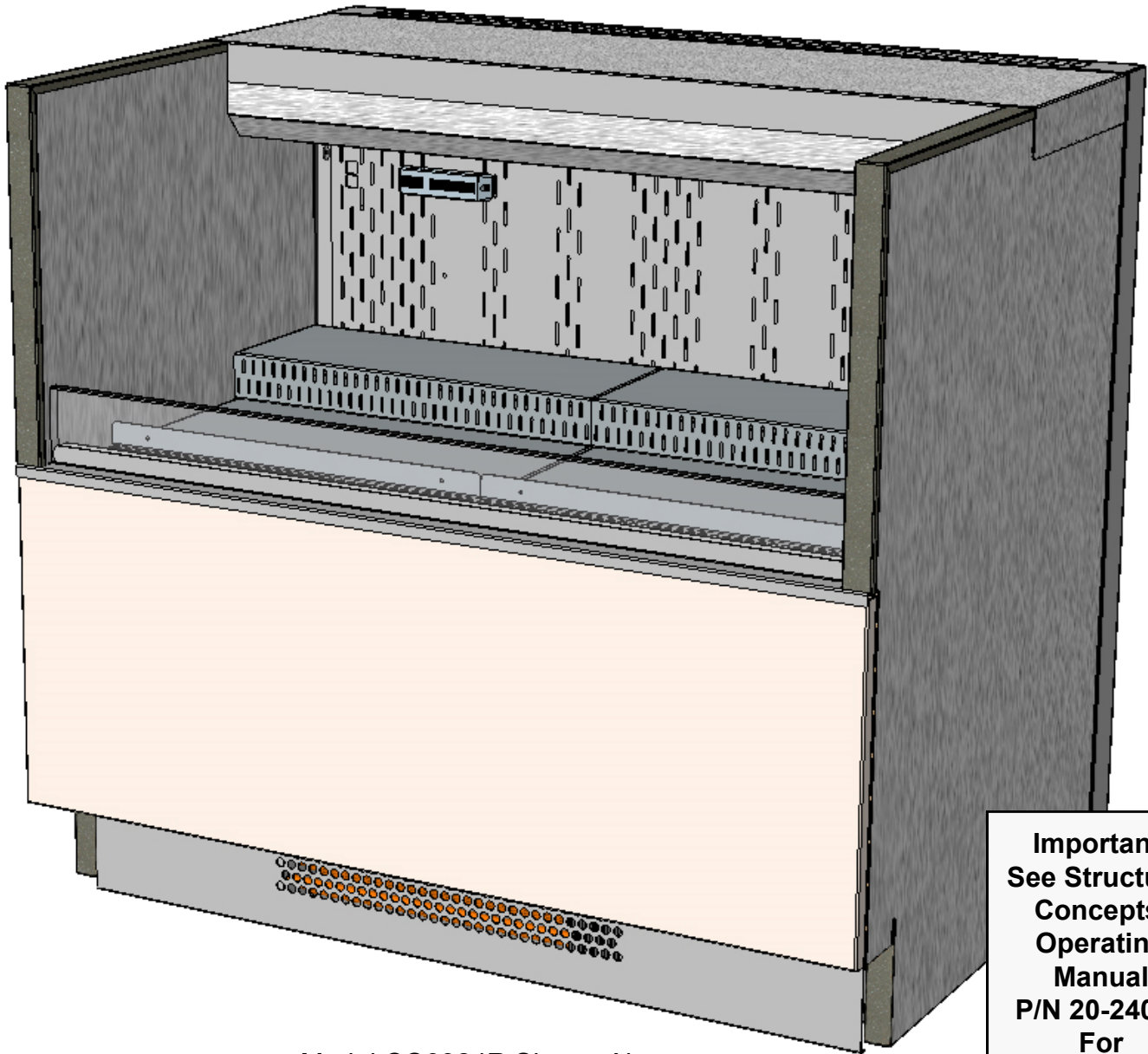

Model CO3324R Shown Above.
It May Not Reflect Every Feature Or
Option of Your Particular Merchandiser.

Important!
See Structural
Concepts'
Operating
Manual
P/N 20-24002
For
Merchandiser
Operating
Instructions.

Structural Concepts[®]

DELIVERING FRESH. ALWAYS.™

Structural Concepts Corp. · 888 E. Porter Rd · Muskegon, MI 49441 Phone: 231.798.8888 Fax: 231.798.4960 · www.structuralconcepts.com

Table of Contents

| | |
|--|-----------|
| CONDENSER PACKAGE ACCESS SECTION | 3 |
| CONDENSER PACKAGE ACCESS (AT CASE FRONT) | 4 |
| CASE FRONT AND REAR LAYOUTS | 5 |
| CASE FRONT LAYOUT | 6 |
| CASE REAR LAYOUT | 7 |
| FRONT MILLWORK AND CABINETRY DESIGN GUIDELINES | 8 |
| FRONT MILLWORK AND CABINETRY DESIGN: HINGED DOORS | 9 |
| CASE TOP LAYOUT | 10 |
| COUNTERTOP LAYOUT - FOR UNITS THAT ARE FLUSH TO A WALL | 11 |
| COUNTERTOP LAYOUT - FOR UNITS THAT ARE NOT FLUSH TO A WALL | 12 |
| SIDE SECTION LAYOUTS | 13 |
| SIDE SECTION LAYOUT - OUTSIDE COUNTER | 14 |
| SIDE SECTION LAYOUT - WITHOUT FRONT CABINETRY MILLWORK (MODEL COXXR-UC) | 15 |
| SIDE SECTION LAYOUT - WITHOUT FRONT CABINETRY MILLWORK (MODEL COXX24R-UC) | 16 |
| SIDE SECTION LAYOUT - MODEL COXXR-UC ONLY / UNDERSIDE OF TOP COUNTER | 17 |
| SIDE SECTION LAYOUT - MODEL COXX24R-UC ONLY / UNDERSIDE OF TOP COUNTER | 18 |

CONDENSER PACKAGE ACCESS SECTION

CONDENSER PACKAGE ACCESS (AT CASE FRONT)

Condenser Package Access (At Case Front)

- You must remove both the front panel and air intake grille to access condenser package.
- Front panel's slots must be lifted off hooks and into front panel opening; lower front panel may then be swung outward and removed from case.
- Air intake grille may be lifted off without screw removal (via slots and/or magnets).
- After front panel and air intake grille are removed, condenser package is accessible.
- Note: Shipment screws may need to be removed.
- Condenser package may be carefully and slowly slid out from under case (as required).
- **Caution! Do NOT slide condenser package all the way out from underside of case!**
- See illustrations below.

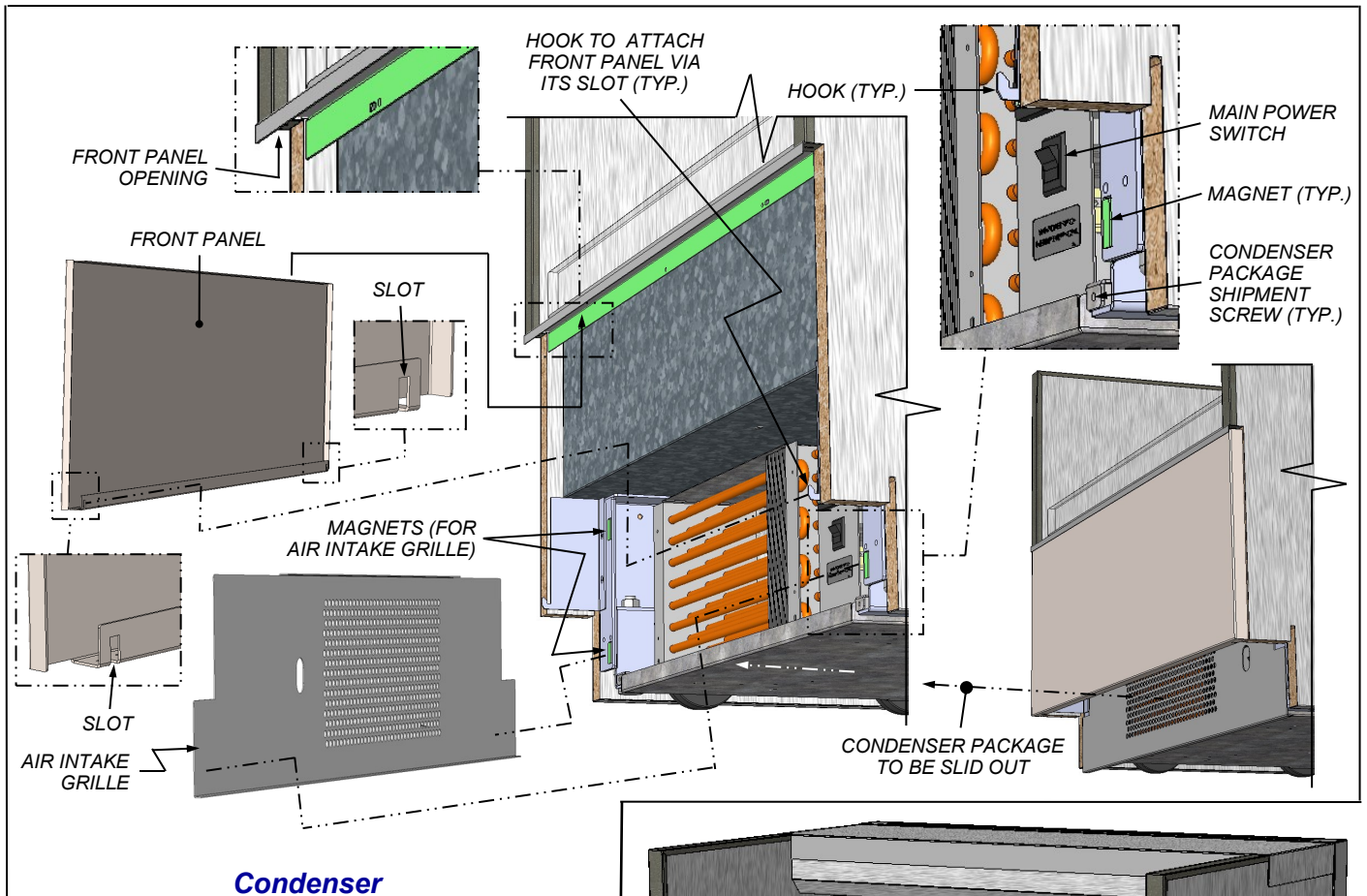

**CAUTION! DO NOT SLIDE
CONDENSER PACKAGE
ALL THE WAY OUT FROM
UNDERSIDE OF CASE AS
THIS COULD DAMAGE
REFRIGERATION LINES
OR HOSES!**

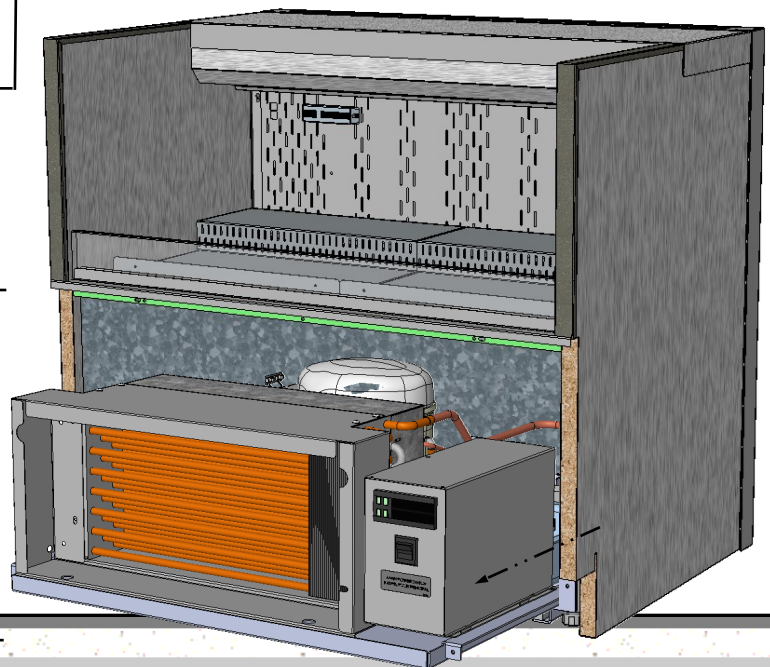

CASE FRONT AND REAR LAYOUTS

CASE FRONT LAYOUT

Case Front Layout

- Carefully follow the instructions listed below.
- Dimensions are in inches.
- See next page for case rear layout.

| MODELS | MINIMUM "U" DIMENSION (OPENING FOR UPPER OPEN AREA) | "V" DIMENSION (REQUIRED COUNTER OPENING FOR FRONT ACCESS CASE AND CONDENSER PACKAGE) |
|-----------------------|---|--|
| CO33R-UC & CO3324R-UC | 34" | 36 1/2" ± .12" |
| CO43R-UC & CO4324R-UC | 45" | 47 1/2" ± .12" |
| CO53R-UC & CO5324R-UC | 57" | 59 1/2" ± .12" |
| CO63R-UC & CO6324R-UC | 69" | 71 1/2" ± .12" |

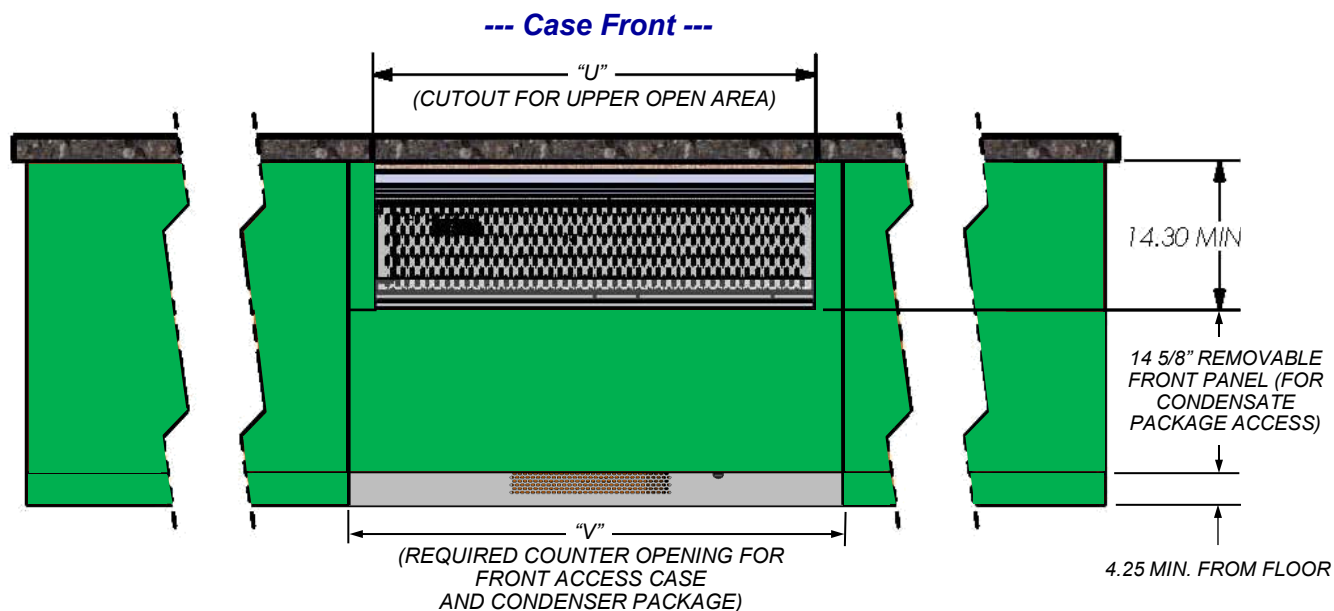

CASE REAR LAYOUT

Case Rear Layout

- Carefully follow the instructions listed below.
- Dimensions are in inches.
- See previous page for case front layout.

| MODELS | "W" DIMENSION (REQUIRED COUNTER OPENING FOR FRONT ACCESS CASE AND CONDENSER PACKAGE) |
|-----------------------|--|
| CO33R-UC & CO3324R-UC | 36 1/2" ± .12" |
| CO43R-UC & CO4324R-UC | 47 1/2" ± .12" |
| CO53R-UC & CO5324R-UC | 59 1/2" ± .12" |
| CO63R-UC & CO6324R-UC | 71 1/2" ± .12" |

CASE REAR VIEW IS SHOWN WITHOUT
REAR SPACER (STANDARD) OR
CHIMNEY (OPTIONAL) FOR
ILLUSTRATIVE PURPOSES ONLY.

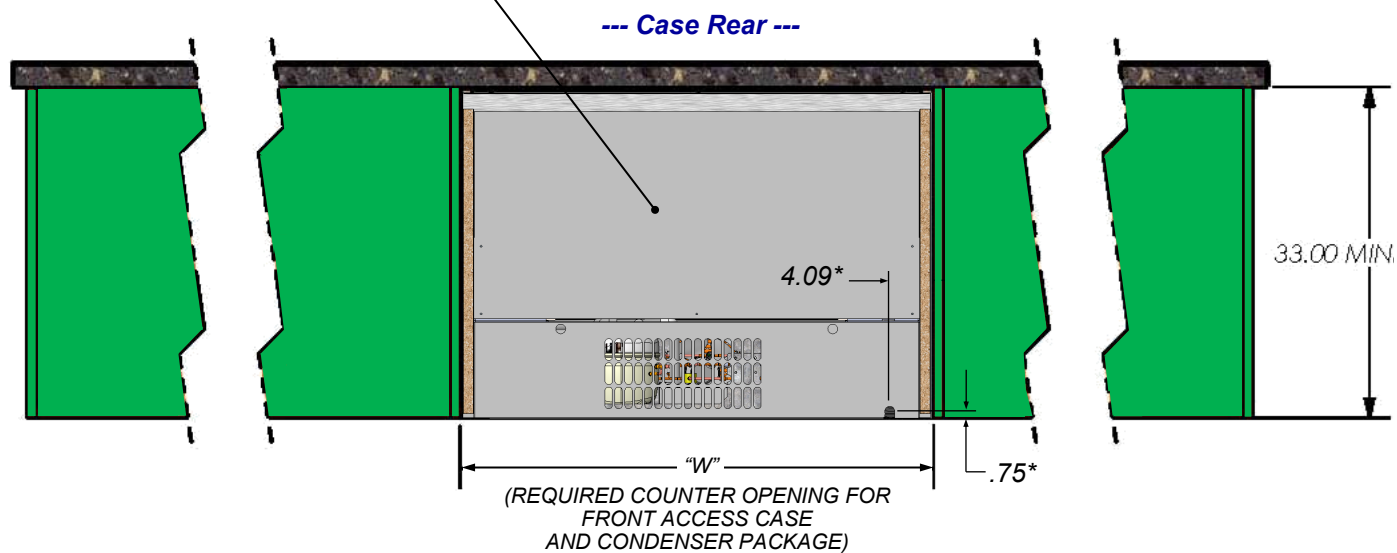

* Note: A 6-foot power cord is supplied and exits the display through the lower rear panel (as shown above). Refer to model specification sheet for electrical requirements and plug configuration.

FRONT MILLWORK AND CABINETS DESIGN GUIDELINES

FRONT MILLWORK AND CABINETRY DESIGN: HINGED DOORS

Hinged Doors

- It is the responsibility of the millwork/cabinetry designer to assure that the front panel is either REMOVABLE or able have its doors OPENED UP (utilizing hinges).
- Front access to case allows condenser package to be slid out from under merchandiser (for service and/or cleaning). It ALSO allows the ENTIRE MERCHANDISER to be slid out from under countertop (for service and/or cleaning).
- Millwork/cabinetry designer must decide on the best method (based on the store/facility counter design) to accomplish these operational requirements.
- Design method shown below reflects millwork/cabinetry that utilizes HINGED DOORS to allow merchandiser to be entirely removed from counter.
- **Caution! Proper airflow must be maintained with air intake grille!** See **SIDE SECTION LAYOUT - WITHOUT FRONT CABINETRY MILLWORK** section in this guide for airflow parameters.

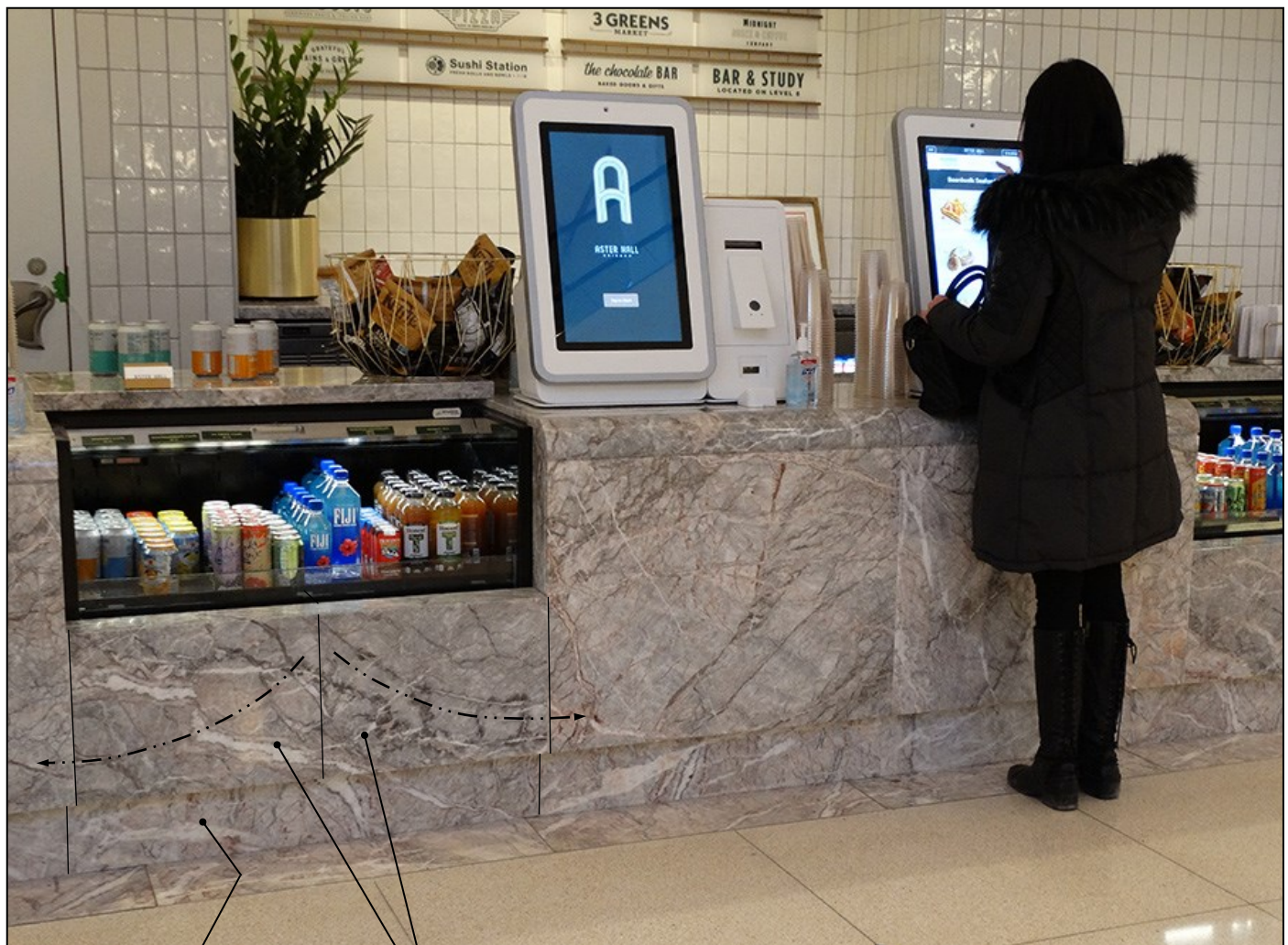

Panel In Front of Air Intake Grille (Removable Via Wide Range of Methods). See Previous Pages For Millwork/ Cabinetry Design Hardware.

Hinged "Doors" (May Be Opened Via Handles or By Simply Grasping Millwork Panel and Opening Outward)

CASE TOP LAYOUT

COUNTERTOP LAYOUT - FOR UNITS THAT ARE FLUSH TO A WALL

Countertop Layout - For Units That Are Flush To A Wall

- Carefully follow the instructions listed below.
- Dimensions are in inches.
- Sample view of front millwork (if any) is shown. Other cabinetry or millwork is not viewable, as it would be at underside of countertop.

| MODELS | MINIMUM "U" DIMENSION (CUTOUT FOR UPPER OPEN AREA) |
|-----------------------|---|
| CO33R-UC & CO3324R-UC | 34" |
| CO43R-UC & CO4324R-UC | 45" |
| CO53R-UC & CO5324R-UC | 57" |
| CO63R-UC & CO6324R-UC | 69" |

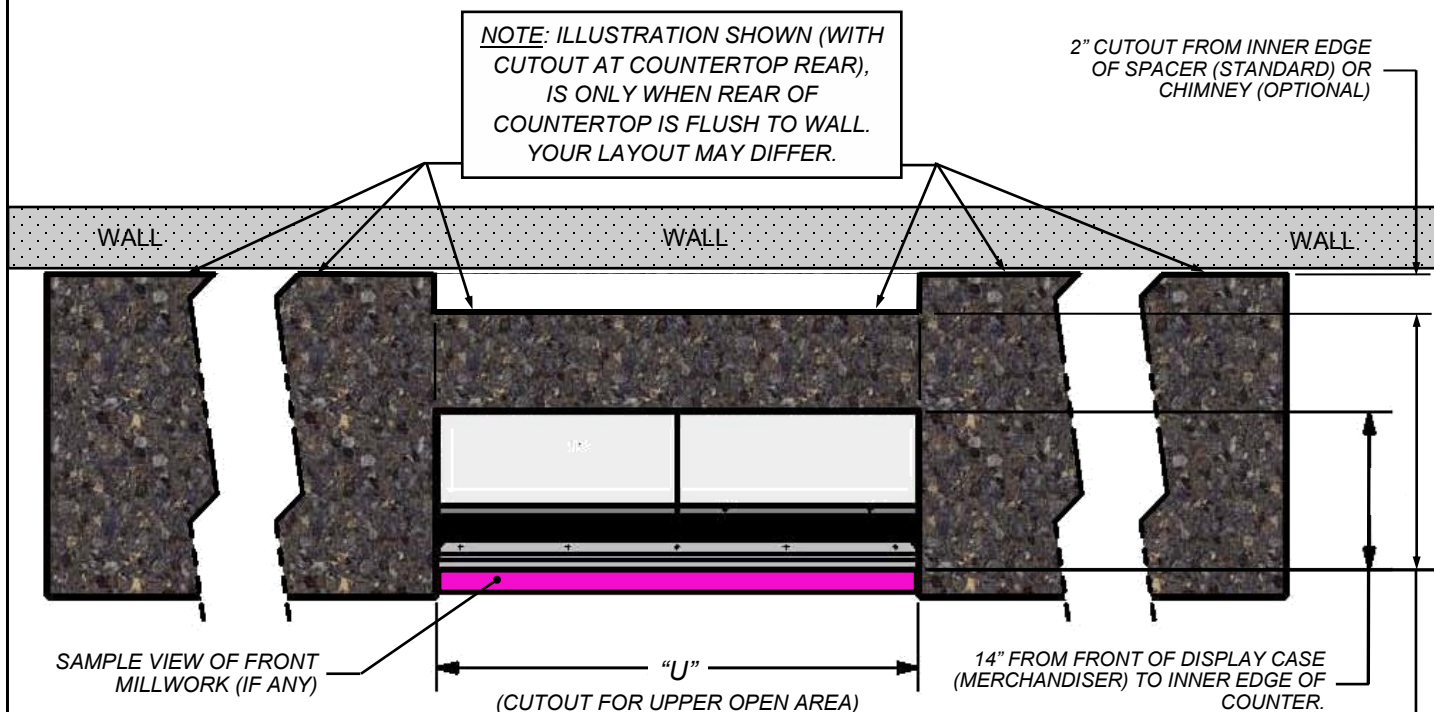

--- Case Front ---

DISTANCE FROM FRONT OF DISPLAY CASE (MERCHANDISER) TO INNER EDGE OF SPACER (STANDARD) OR CHIMNEY (OPTIONAL) CUTOUT =
 A. 32 5/16" FOR COXXR-UC CASES
 B. 24" FOR COXX24R-UC CASES

CAUTION! THIS CUTOUT IS ONLY WHEN REAR OF COUNTERTOP IS FLUSH TO WALL.*

* **IMPORTANT NOTE:** THIS PAGE SHOWS FRONT ACCESS UNITS THAT ARE FLUSH AGAINST A WALL. SEE NEXT SECTION IN THIS GUIDE FOR UNITS THAT ARE NOT FLUSH TO WALL.

COUNTERTOP LAYOUT - FOR UNITS THAT ARE NOT FLUSH TO A WALL

Countertop Layout - For Units That Are Not Flush To A Wall

- Carefully follow the instructions listed below.
- Dimensions are in inches.
- Sample view of front millwork (if any) is shown. Other cabinetry or millwork is not viewable, as it would be at underside of countertop.

| MODELS | MINIMUM "U" DIMENSION (CUTOUT FOR MERCHANTISER'S UPPER OPEN AREA) |
|-----------------------|---|
| CO33R-UC & CO3324R-UC | 34" |
| CO43R-UC & CO4324R-UC | 45" |
| CO53R-UC & CO5324R-UC | 57" |
| CO63R-UC & CO6324R-UC | 69" |

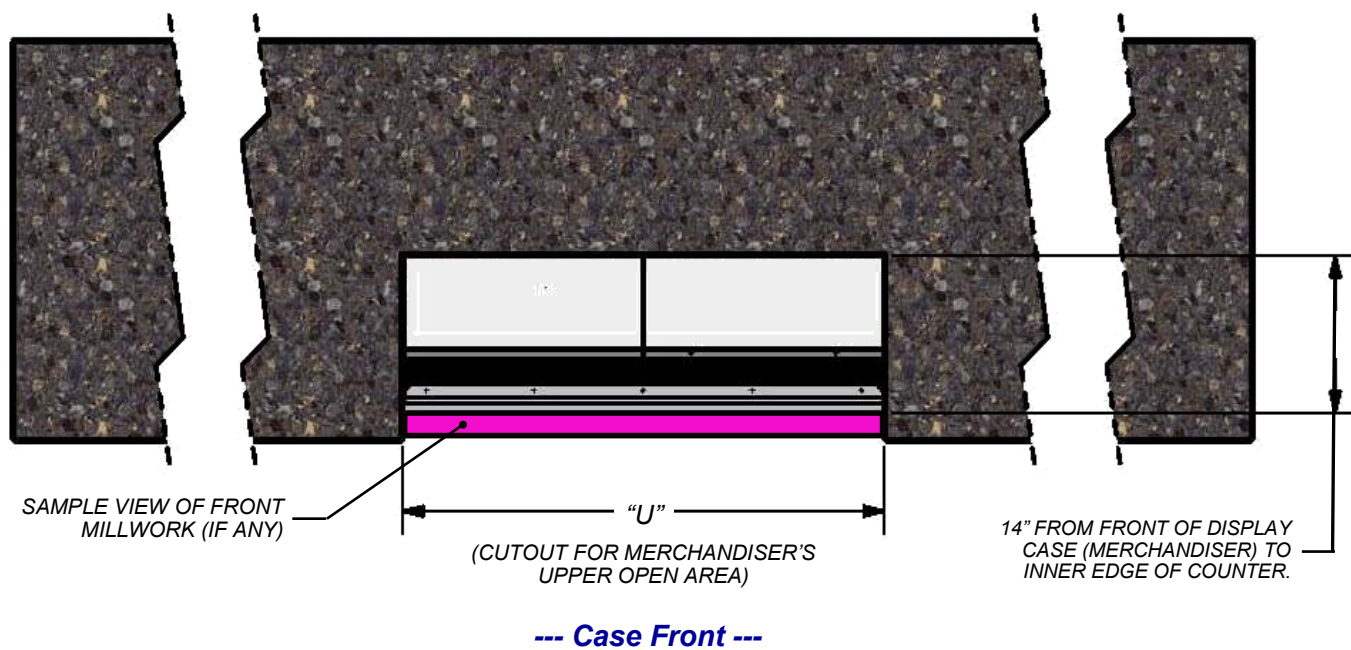

* IMPORTANT NOTE: THIS PAGE SHOWS FRONT ACCESS UNITS THAT NOT FLUSH AGAINST A WALL. SEE PREVIOUS SECTION IN THIS GUIDE FOR UNITS THAT ARE FLUSH TO WALL.

SIDE SECTION LAYOUTS

SIDE SECTION LAYOUT - FRONT CABINETRY MILLWORK INSTRUCTIONS

Side Section Layout - Front Cabinetry Millwork Instructions

- Structural Concepts DOES NOT provide cabinetry millwork. Proper forming, fit and function is the responsibility of customer. These instructions are to be used as general guidelines to assure cabinetry that allows for proper operation of merchandiser.
- **Important! Front cabinetry millwork MUST NOT BE attached to merchandiser! Otherwise, merchandiser will not be able to be slid in and out from front of case.**
- Carefully follow the instructions listed below.
- Dimensions are in inches.

--- Side Section Inside Front Cabinetry ---

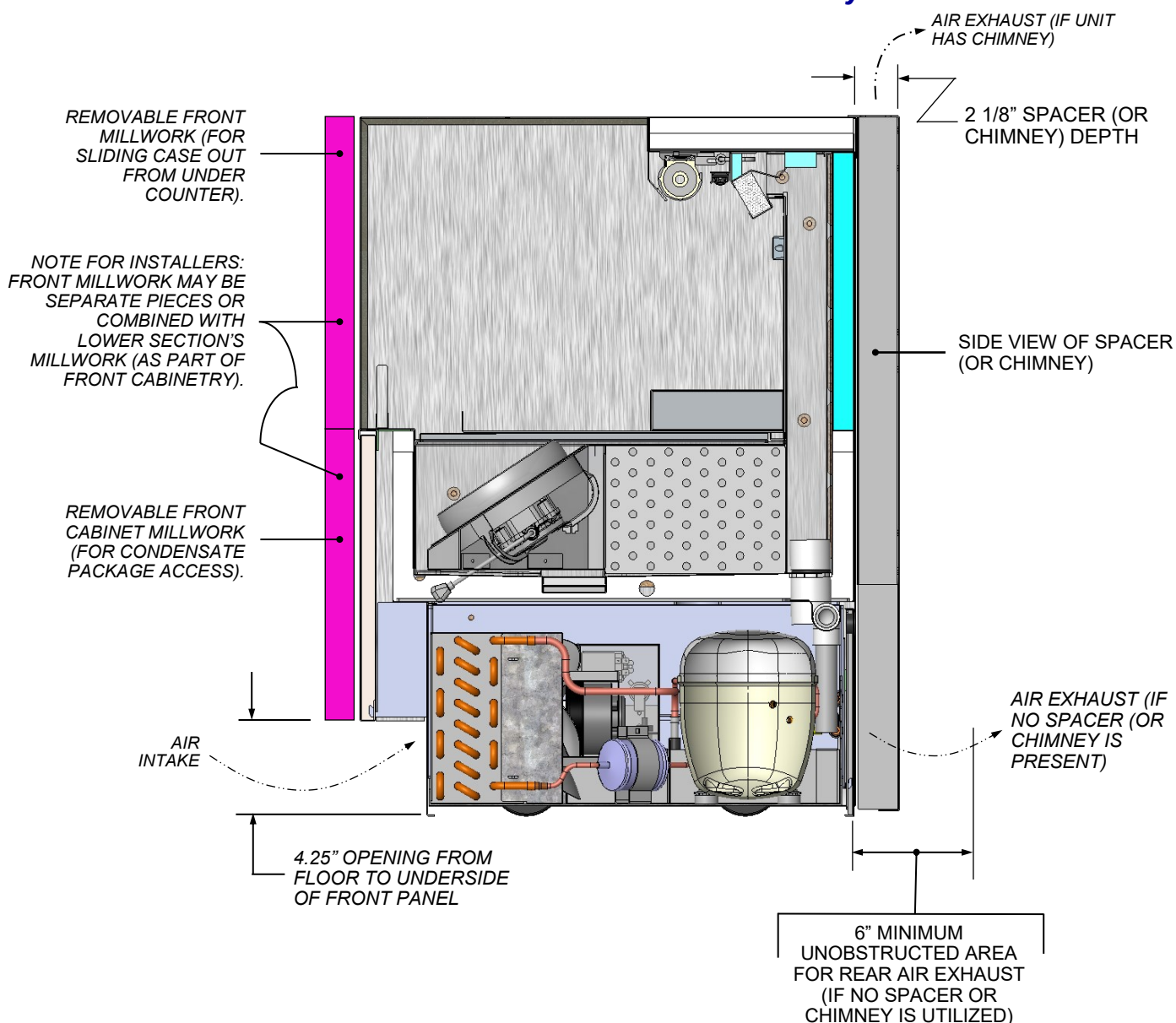

SIDE SECTION LAYOUT - WITHOUT FRONT CABINETRY MILLWORK (MODEL COXXR-UC)

Side Section Layout - Without Front Cabinetry Millwork (COXXR-UC)

- Structural Concepts DOES NOT provide cabinetry millwork as part of your installation. Proper form, fit and function of cabinetry is the responsibility of customer. If cabinetry IS NOT IN FRONT OF MERCHANDISER, it is up to in-field cabinetry maker to align front of merchandiser with other cabinets/counters.
- Carefully follow the instructions listed below.
- Dimensions are in inches.
- **Important! Below illustration is for merchandisers WITHOUT front cabinetry millwork provided in the field.**

--- Side Section Outside Counter ---

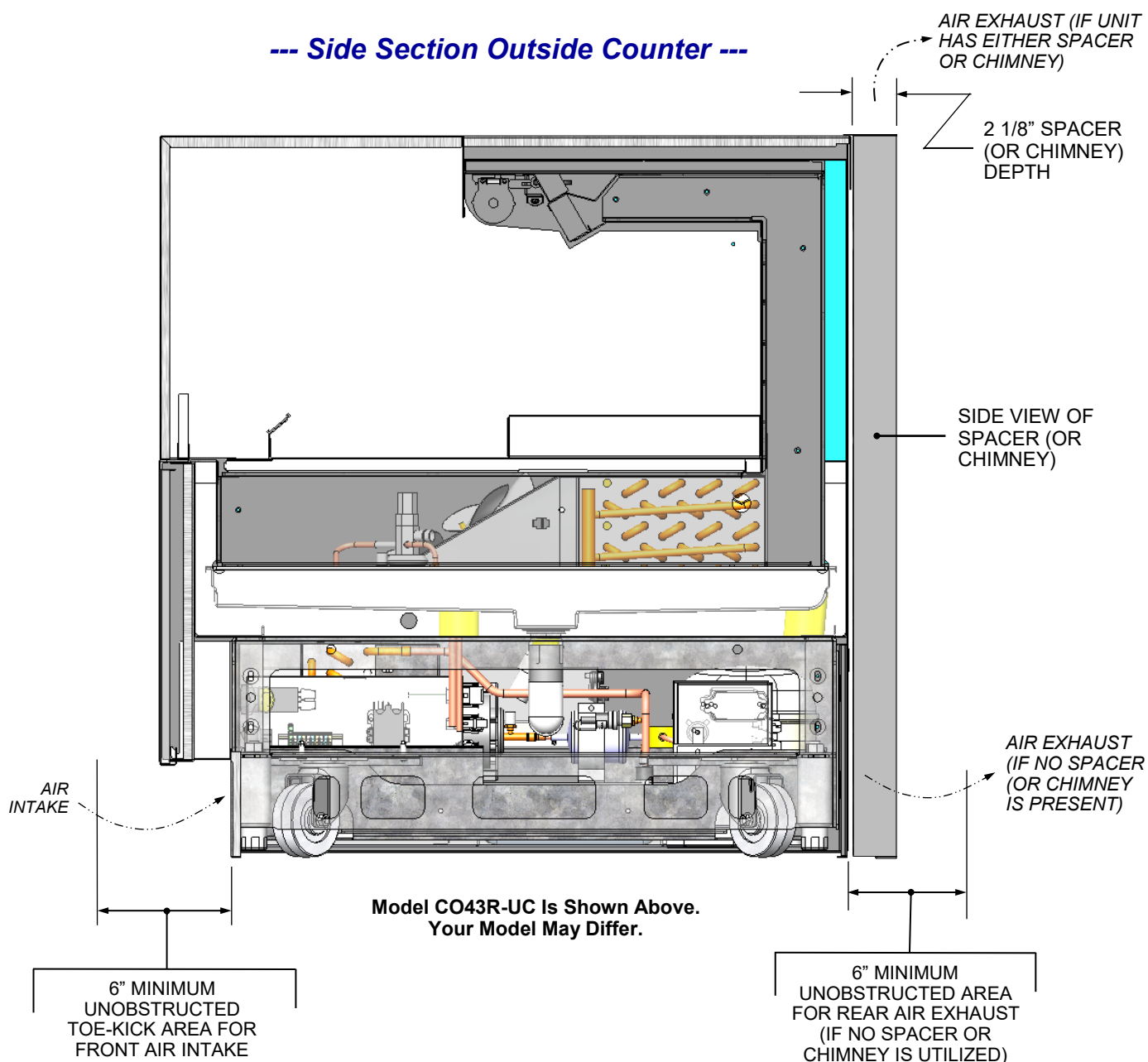

SIDE SECTION LAYOUT - WITHOUT FRONT CABINETRY MILLWORK (MODEL COXX24R-UC)

Side Section Layout - Without Front Cabinetry Millwork (COXX24R-UC)

- Structural Concepts DOES NOT provide cabinetry millwork as part of your installation. Proper form, fit and function of cabinetry is the responsibility of customer. If cabinetry IS NOT IN FRONT OF MERCHANDISER, it is up to in-field cabinetry maker to align front of merchandiser with other cabinets/counters.
- Carefully follow the instructions listed below.
- Dimensions are in inches.
- **Important! Below illustration is for merchandisers WITHOUT front cabinetry millwork provided in the field.**

--- Side Section Outside Counter ---

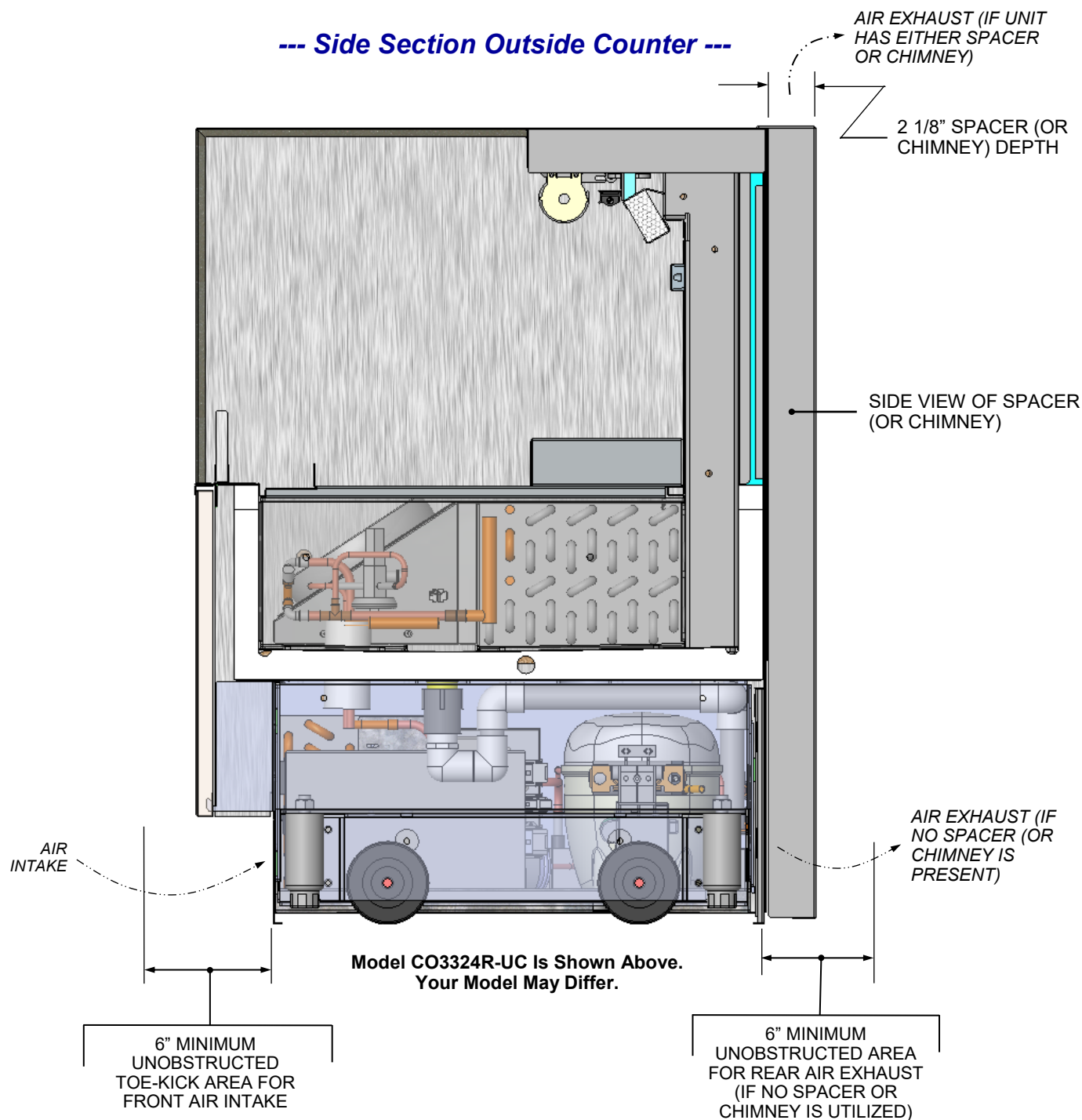

SIDE SECTION LAYOUT - MODEL COXXR-UC ONLY / UNDERSIDE OF TOP COUNTER

Side Section Layout - Underside of Top Counter

- **Important! Counter Top Must NOT be attached to case!**
- Carefully follow the instructions listed below.
- Dimensions are in inches.
- See next page for side section layout model COXX24R-UC at underside of top counter.

--- Model COXXR-UC Side Section Layout / Underside Of Top Counter ---

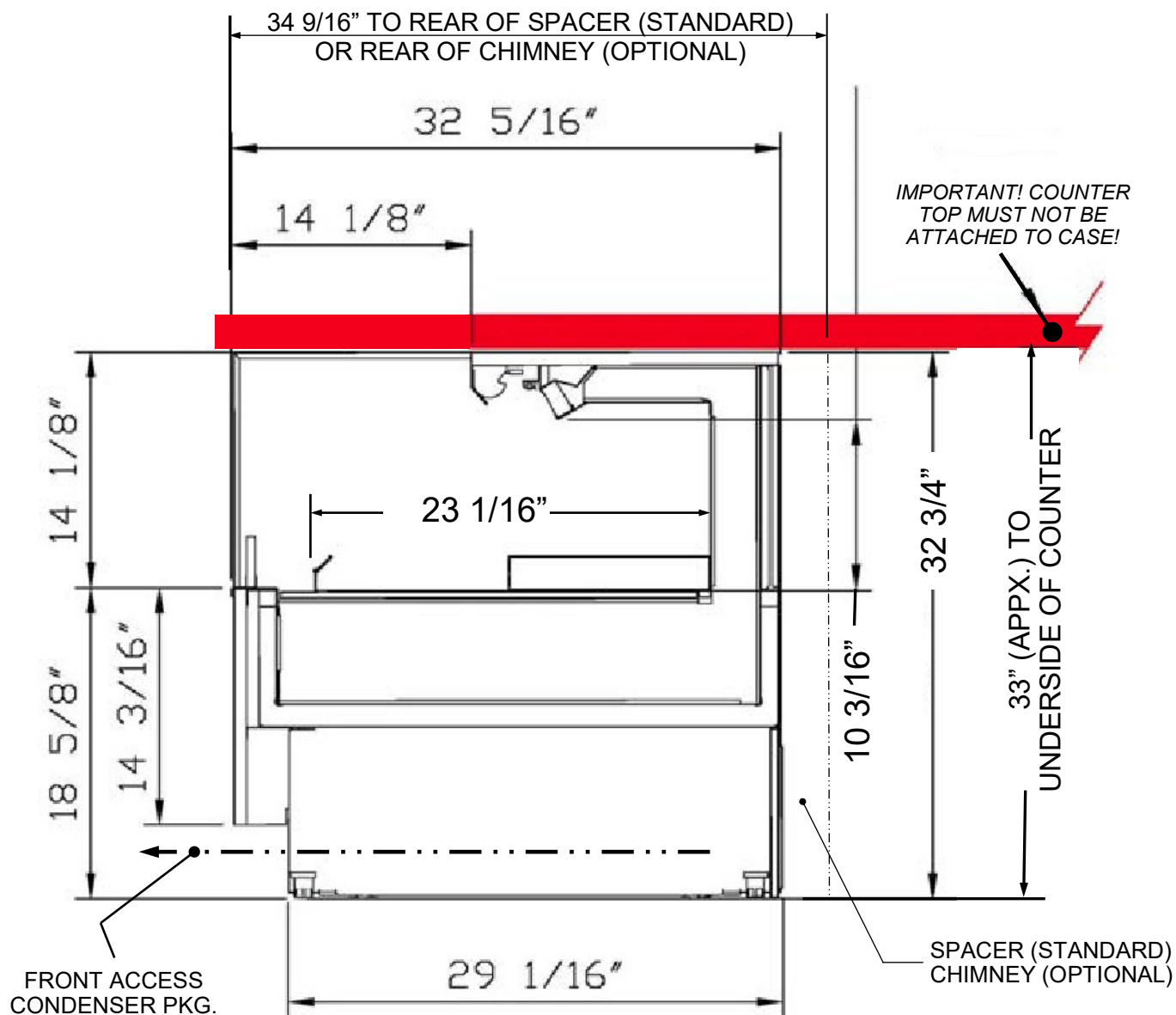

SIDE SECTION LAYOUT - MODEL COXX24R-UC ONLY / UNDERSIDE OF TOP COUNTER

Side Section Layout - Underside of Top Counter

- **Important! Counter Top Must NOT be attached to case!**
- Carefully follow the instructions listed below.
- Dimensions are in inches.
- See previous page for side section layout model COXXR-UC at underside of top counter.

--- Model COXX24R-UC Side Section Layout / Underside Of Top Counter ---

